

DOCUMENT 00900

ADDENDA

GENERAL

1.01 The following sets forth the format for issued Addenda.

ADDENDUM NO. 2 – Date: March 5, 2021

RE: RSD- Exterior Paint and Misc. Cosmetic Repairs at Janson ES and Savannah ES

FROM: Rosemead School District
3907 Rosemead Blvd.
Rosemead, CA 91770

To: All Prospective Bidders

This Addendum forms a part of the Contract Documents and modifies the Bidding Documents (dated Drawings-01/08/21 for Exterior Paint and Misc. Cosmetic Repairs at Janson ES and Savannah ES as noted below. Acknowledge receipt of the Addendum in the space provided in the Bid Form. Failure to do so may result in the Bid being deemed non-responsive.

The Addendum consists of the following items:

- A. CHANGES TO BIDDING REQUIREMENTS: NONE
- B. CHANGES TO PRIOR ADDENDUM: NONE
- C. CHANGES TO BIDDING DOCUMENTS: NONE
- D. CHANGES TO CONDITIONS OF THE CONTRACT: NONE
- E. CHANGES TO GENERAL CONDITIONS: NONE
- F. CHANGES TO SPECIFICATIONS: NONE
- G. CHANGES TO DRAWINGS:

1. Janson ES Site, Sheet A1.01:

- a) **REVISED:** General Site Note “E”
- b) **ADD:** General Site Note “Q”
- c) **REVISED:** Key Note No. 9
- d) **ADD:** Reference to Key Note 18 on North Planter
- e) **ADD:** Key Note No. 45 and reference on the Site Plan

2. Savannah ES Site, Sheet A1.01:

- a) **REVISED:** General Site Note “E”

ADDENDUM No. 2

Page 2

- b) **ADD:** General Site Note "S"
- c) **REVISED:** Key Note No. 16
- d) **ADD:** Key Note No. 44 and reference on the Site Plan

H. QUESTIONS FROM BIDDERS:

A. Questions/Comments mentioned during the February 18, 2021 mandatory Job Walk

- 1. Question:** What is the scope for the "quotes" located on the eave's fascia boards?

Response: Quotes on eave's fascia boards shall be painted over and re-painted to match (E). See revised Site Plan. Comply with General Site Note "Q" on sheet A1.01

- 2. Question:** Is the privacy paint behind the existing glazing included in the Scope? (Applicable for both Sites)

Response: Comply with Key Note No. 4 of the Bid Drawings dated 12/01/2020

- 3. Question:** Can Portable Classrooms be spray painted? (Applicable for both Sites)

Response: No. Comply with Section 09910, 4.02-A of the Specifications dated March 9, 2021.

- 4. Question:** Is the tree well on the North Side of Janson's play yard included in the Scope of Work?

Response: Yes, painting of planter is included. See revised Site Plan on sheet A1.01

- 5. Question:** At Janson ES: Is the repair of the underside of portable plywood overhang included in the Scope of Work?

Response: Yes, comply with Key Note No. 45 on revised Site Plan, sheet A1.01.

- 6. Question:** Clarification of (E) storage "barns" (Applicable for both Sites)

Response: Existing storage "barns" are not to be included in the Scope of Work. Comply with revised Key Note No. 9 on sheet A1.01 for Janson ES Site and with revised Key Note No. 16 on A1.01 for the Savannah ES Site

- 7. Question:** Are the pipes and conduits on top of (E) canopies included in the Scope of Work? (Applicable for both Sites)

Response: No. Comply with revised General Site Note "E" on sheet A1.01 for Janson ES and Savannah ES set of drawings.

ADDENDUM No. 2

Page 3

- 8. Question:** At the Savannah Site: Will (E) CMU that is currently not painted be provided with new paint?

Response: No, Comply with General Site Note "S" on sheet A1.01 of the Savannah ES Site

- 9. Question:** At the Savannah Site: Do the doors at the North and South ends of the breezeway going to be painted in full (all sides)?

Response: Yes, comply with Key Note No. 44 on sheet A1.01 of the Savannah ES Site

B. RFI No. 1 Received from GDL Painters Inc. on February 28, 2021

- 1. Question:** What type of license it is required for the Jason and Savannah painting projects?
C33 Correct?

Response: Yes, C-33 Painting and Decorating.

C. RFI No. 1 Received from Omega Construction on March 2, 2021

- 1. Question:** keynote 17 – Alternate 1: Are we doing the painting of fence in alternate where only noted on drawings with item 17? The reason on the North East side there is some fence by the parking lot and behind 4 Bungalows. See sketch. Please clarify

Response: Portion of fencing indicated on the Site Plan provided by Omega Construction is chain link, not wrought iron. Therefore, no paint scope is included in this portion of fencing. However, the only portion of fencing to be painted along the East fence is located at the South turn of the wrought iron fence as shown on sheet A1.01 of the attached revised drawings.

- 2. Question:** Keynote 26 it indicates Window on building and keynote refers to detail 2/A6.01, which addresses Wood Trim & Flashing typical of T1-11 walls. Is there a window to repair? Please clarify

Response: No, window repairs are not included in the Scope of Work. Keynote No. 26 refers to window trim, not the window.

- 3. Question:** Keynote 2: Can you provide footage, e.g 30 feet? Please Provide detail

Response: Keynote 2 is related to door scope of work. Lineal footage reference is not applicable.

- 4. Question:** Keynote 29: Are you changing scope of this note?

Response: No, Scope of Work described on keynote No. 29 is correct

END OF ADDENDUM NO. 2

KEYNOTES

- ALL (E) EXTERIOR WALLS TO BE PAINTED. ALL (E) FIRST RESPONDERS SIGNAGE TO REMAIN. DO NOT PAINT OVER IT
 - ALL (E) EXTERIOR DOORS AND FRAMES TO BE PAINTED. PROVIDE EXTERIOR DOOR BRANDING PER DETAIL: 1/A6.01
 - REMOVE AND REPLACE (E) T1-11 PANEL IN KIND (MATCH SIZE). SCOPE SHALL INCLUDE REMOVAL OF DAMAGED BUILDING PAPER, INSULATION AND SHT. MTL. FLASHING. RE-DO ANY (E) PAINTED SIGNAGE AFFECTED BY THE REMOVAL OF T1-11 PANELS TO MATCH (E). (N) T1-11 PANELS SHALL BE PRE-FINISHED SMOOTH. PROVIDE ALL NECESSARY WOOD TRIM AT TRANSITIONS AS REQUIRED TO MATCH (E)
 - ALL (E) BRONZE ANODIZED METAL WINDOWS ON SITE TO BE PAINTED (SPRAY) JANSON ACCENT COLOR INCLUDING ALL SPANDREL FRAME AND PANELS. REMOVE SLIDING TRACK PARTS FROM ALL WINDOWS THAT HAVE BEEN SECURED SHUT PRIOR TO PAINTING
 - REMOVE AND REPLACE (E) FASCIA BOARD AND (E) FLASHING PAINT TO MATCH (E). (N) FLASHING TO MATCH (E) GAUGE AND PROFILE. PAINT JANSON ACCENT COLOR
 - REMOVE FIRE HOSE CONNECTION FROM (E) CABINET. PROVIDE (N) LOCKABLE BULLETIN BOARD PER DETAIL 4/A6.01
 - NOT USED
 - ALL (E) GUARDRAILS, HANDRAILS AND DRINKING FOUNTAIN RAILS ON SITE TO BE PAINTED. INCLUDING GUARDRAILS / HANDRAILS WITH JANSON ACCENT COLOR SPEC
 - ALL (E) SHEDS AND CONTAINERS (EXCEPT FOR STORAGE "BARN") ON SITE TO BE PAINTED JANSON ACCENT COLOR PER SPEC. TRIM TO BE PAINTED WHITE (SWISS COFFEE) WHERE OCCURS. DO NOT PAINT OVER (E) LABELS AND ID PLAQUES WHERE OCCURS
 - BASE BID:** DO NOT PAINT (E) WROUGHT IRON PERIMETER FENCING.
- ALTERNATE 1:** ENTIRE WROUGHT IRON FENCING AND GATES ON SITE TO BE PAINTED (SPRAY) JANSON ACCENT COLOR PER SPEC (DUNN EDWARDS, ARISTASHIELD). ALL (E) BANNERS MOUNTED ON (E) FENCE SHALL BE REMOVED, STORED, PROTECTED AND REINSTALLED AFTER PAINT APPLICATION. (E) LOW CMU WALL UNDER WROUGHT IRON FENCE TO BE PAINTED (SWISS COFFEE BY DUNN EDWARDS, EVERSIELD) WHERE OCCURS
- PROVIDE JANSON ACCENT COLOR PER SPEC TO ALL SIDES OF ALL (E) GUTTERS AND DOWNSPOUTS ON SITE. ALL (E) SHEET METAL EDGE FLASHING AT ROOF (TOP AND VISIBLE FACE) SHALL BE PAINTED JANSON ACCENT COLOR PER SPEC
 - REMOVE AND REPLACE (E) WOOD TRIM IN KIND. PAINT TO MATCH (E)
 - PROVIDE (N) PAINT AT (E) CONC. PAVED PATIO (SLAB AND EDGES) AND PLANTERS (WHERE OCCURS) PER PAINT SPEC.
 - PROVIDE (N) JANSON ACCENT COLOR PAINT (PER SPEC) TO ALL SIDES (INCLUDING TOP AND BOTTOM) OF (E) AWNING AND SUPPORT MEMBERS
 - (E) CMU WALL TO BE PAINTED (CONCRETE COLOR, DUNN EDWARDS, EVERSIELD)
 - PROVIDE (N) PLASTER PATCH TO MATCH (E) TEXTURE AND FINISH
 - (E) BASKETBALL POST TO BE PAINTED TO MATCH (E)
 - ALL VISIBLE SIDES OF (E) PLANTER TO BE PAINTED WHITE PER SPEC
 - PAINT SIDES AND CURBS (JANSON ACCENT COLOR) AT (E) PLATFORM PER PAINT SPEC AND PROVIDE MISSING HANDRAIL END CAP
 - (E) ABANDONED FIRE EXTINGUISHER CABINET TO BE REMOVED. PROVIDE PLASTER PATCH AS REQUIRED TO MATCH (E) TEXTURE AND FINISH
 - PROVIDE PLASTER PATCH AND EDGE TRIM AT CORNER TO MATCH (E) TEXTURE AND FINISH

- ALL (E) WOOD WINDOWS TO BE PAINTED JANSON ACCENT COLOR PER SPEC
- PROVIDE (N) FIRST RESPONDERS SIGNAGE TO MATCH (E) LOCATED AT NORTHEAST CORNER OF BUILDING. (E) FIRST RESPONDERS SIGNAGE LOCATED AT NORTHEAST CORNER OF THE BUILDING. TO BE PAINTED OVER
- ALL (E) CLASSROOM No. RANGE STENCILED IN BLACK TO BE PAINTED OVER
- REMOVE AND REPLACE (E) DRY-ROTTED LEDGER BLOCKING AND PROVIDE PAINT TO MATCH (E)
- PROVIDE PLASTER PATCH FROM BOTTOM OF WALL TO 18" A.F.F. TO MATCH (E) TEXTURE AND FINISH
- EXISTING METAL ENCLOSURE TO BE PAINTED JANSON ACCENT COLOR PER SPEC.
- REMOVE AND REPLACE DAMAGED PORTION OF DIAGONAL SHEATHING AND PROVIDE PAINT TO MATCH (E)
- (E) FASCIA TO BE REMOVED AND REPLACED. PROVIDE JANSON ACCENT PAINT FOR FASCIA AND SHT. MTL. FLASHING PER SPEC
- REMOVE AND REPLACE DRY-ROTTED PORTIONS OF WOOD HANDRAIL. MATCH LUMBER SIZE. PROVIDE JANSON ACCENT PAINT COLOR PER SPEC TO ENTIRE WOOD HANDRAILS
- FILL SPALL AT (E) CONCRETE SLAB
- (E) VERTICAL CONDUIT RUNS TO BE PAINTED WHITE COLOR PER SPEC
- REMOVE AND REPLACE WOOD PANELS AND TRIM. MATCH (E) SIZE, FINISH AND COLOR
- REPLACE LAST 12" OF DAMAGED CANOPY JOIST. PAINT TO MATCH (E)
- REMOVE AND REPLACE (E) T1-11 SKIRT AND INSTALL (N) MTL. CAP. PAINT TO

- MATCH (E) PER SPEC.
- REMOVE AND REPLACE (E) WINDOW IN THEIR ENTIRETY. TRIM TO MATCH (E) SIZE. PROVIDE JANSON ACCENT COLOR PAINT
 - REMOVE AND REPLACE (E) DOWNSPOUT TO MATCH (E) SIZE AND PROFILE. PROVIDE JANSON ACCENT COLOR PAINT PER SPEC
 - REMOVE AND REPLACE SKIRT AND ALUM. VENTS IN KIND
 - REPAIR (E) MARKEE GLADDING AND PROVIDE (N) JANSON ACCENT COLOR PER SPEC. MATCH (E) TEXTURE
 - PAINT (E) CMU WALL. LOWER HALF OF WALL SHALL BE PAINTED JANSON ACCENT COLOR (EVERSHIELD). TOP HALF OF WALL SHALL BE PAINTED "SWISS COFFEE" BY DUNN EDWARDS (EVERSHIELD)
 - PROVIDE FIRST RESPONDERS SIGNAGE PER DETAIL: 5/A6.01
 - REMOVE AND REPLACE (E) WOOD STEP. PROVIDE (N) FRAMING (INCLUDE MID-SPAN SUPPORT FRAMING) AND PLYWOOD TO MATCH (E); PAINT JANSON ACCENT COLOR.
 - REMOVE AND REPLACE (E) DAMAGED LOUVER VENT TO MATCH (E) SIZE AND PROFILE. ADJACENT (E) CEMENT PLASTER TO BE MODIFIED AS REQUIRED. (N) CEMENT PLASTER TO MATCH (E) TEXTURE AND FINISH
 - REMOVE AND REPLACE DRY ROTTED WOOD AT UNDERSIDE OF EAVE AND PROVIDE PAINT "SWISS COFFEE" BY DUNN EDWARDS, EVERSIELD
 - PROVIDE (N) 1" PLYWOOD TO COVER ENTIRE DAMAGED SECTION AT UNDERSIDE OF PORTABLE OVERHANG. NEW FASTENERS PROVIDED FROM UNDERSIDE SHALL NOT PENETRATE THE ROOFING MEMBRANE ABOVE.

GENERAL SITE NOTES

- ALL DEMOLITION/ALTERATIONS SHALL COMPLY WITH CHAPTER 34 CBC AND CHAPTER 14 CFC.
- REMOVAL AND REPLACEMENT OF (E) T1-11 PANELS SHALL INCLUDE REMOVAL AND REPLACEMENT OF DAMAGED/DETERIORATED CAULKING, BUILDING PAPER, INSULATION AND/OR SHEET METAL FLASHING. PROVIDE NEW BLOCKING/BACKING WERE REOD, TO MATCH IN KIND
- REMOVAL, REPLACEMENT, PATCHING AND ANY NEW CEMENT PLASTER ASSEMBLY SHALL INCLUDE NEW BUILDING PAPER, NEW INSULATION, NEW SHEATHING AND NEW FLASHING WHERE OCCURS AND WHERE REOD. ALL COMPONENTS AND FINISH TO MATCH (E)
- ALL (E) WALL MOUNTED BULLETING BOARD(S), DISPLAY CASE(S) AND SIGNAGE TO BE REMOVED, PROTECTED, STORED AND RE-INSTALLED AT (E) LOCATION AFTER ALL REPAIR(S) AND / OR PAINT APPLICATION IS COMPLETED
- ALL (E) EXTERIOR CONDUIT AND ELECTRICAL BOXES TO BE PAINTED TO MATCH THE COLOR OF THE WALL WHERE INSTALLED. DO NOT PAINT OVER ANY ELECTRICAL, WARNING LABELS OF ANY KIND, PAINTING OF (E) CONDUIT AND/OR PIPES ABOVE CANOPIES ARE NOT INCLUDED IN THE SCOPE OF WORK
- APPLICATION OF (N) PAINT AT (E) SURFACES SHALL INCLUDE POWER WASHING OF (E) SURFACE PER PAINT SPEC. (E) SURFACES TO BE PAINTED SHALL INCLUDE: WALLS, CEILINGS, UNDERSIDE OF CANOPIES, CANOPY POSTS, UNDERSIDE OF EAVES, CMU WALLS, EXTERIOR DOORS, WINDOWS, POSTS COLUMNS, ETC. ALL (E) PEELING AND/OR BUBBLING PAINT FINISH TO BE REMOVED PRIOR TO PAINT APPLICATION PER SPEC
- ALL (E) BRONZE/NATURAL ANODIZED METAL WINDOWS ON SITE TO BE PAINTED.
- SCOPE OF WORK INCLUDES RE-ATTACHMENT OF ALL (E) POPPED NAILS AND/OR SCREWS IN THE AREA OF WORK
- SCOPE OF WORK SHALL INCLUDE REMOVAL AND RE-INSTALLATION OF ANY PORTABLE CLASSROOM SERIAL NUMBER TAGS AS REQUIRED. DO NOT PAINT OVER SERIAL TAGS
- SCOPE OF WORK SHALL INCLUDE NEW CAULKING AT T1-11 PERIMETER AS REQUIRED PRIOR TO PAINTING (TO MATCH EXISTING)
- PROVIDE NEW SEALANT AT ALL CONDUIT PENETRATIONS INCLUDED IN THE SCOPE OF WORK
- NO PARTS OF THE FIRST RESPONDERS BUILDING IDENTIFICATION LABELING SHOULD BE COVERED OR BLOCKED BE THE NEW PAINTING SCOPE OF WORK
- PAINT SCOPE DOES NOT INCLUDE PAINTING OF (E) TRANSFORMER(S) OR SWITCHGEAR(S)
- ALL (E) GAS LINES ON SITE TO BE PAINTED "SWISS COFFEE" BY DUNN EDWARDS (ARISTOSHIELD)
- ALL WOOD TRIM (EXISTING AND NEW) TO RECEIVE NEW JANSON ACCENT COLOR PAINT AT ALL VISIBLE SIDES
- PAINTING OF DOWNSPOUTS TO INCLUDE THE FULL LENGTH OF THE DOWNSPOUT. FROM GUTTER TO DISCHARGE AT BOTTOM
- ALL (E) LITERARY QUOTES LOCATED AT BUILDING EAVES FASCIA BOARDS OR WALLS TO BE PAINTED OVER WITH ITS RESPECTIVE BACKGROUND COLOR AND THE QUOTE TO BE RE-PAINTED TO MATCH (E) COLOR, FONT AND SIZE

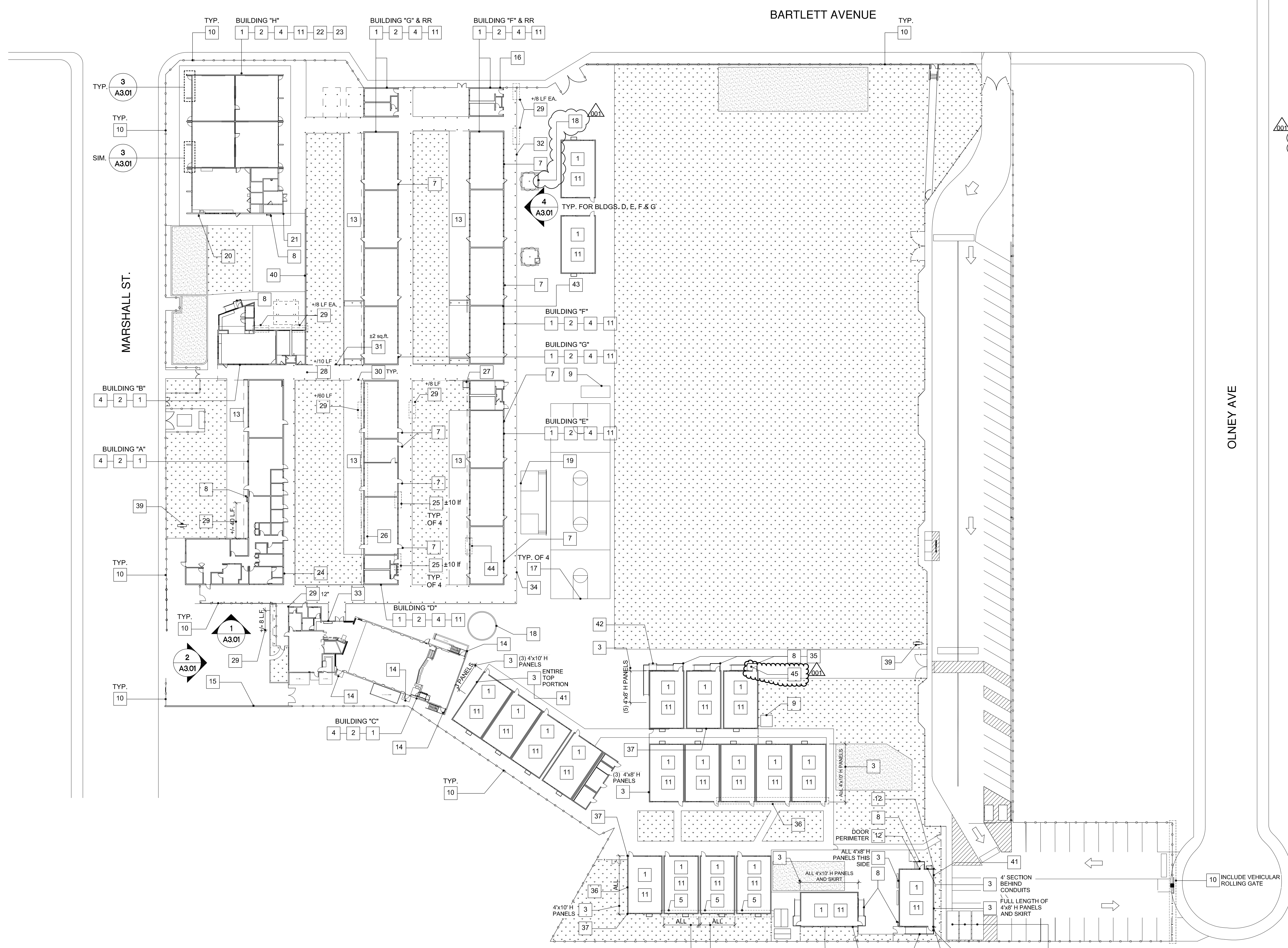

1 JANSON ES | SITE PLAN - SCOPE OF WORK
SCALE: 1/32" = 1'-0"



ADDENDUM 001 | 03/03/2021

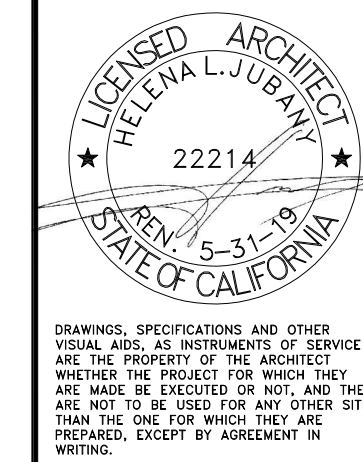

ROSEMEAD SCHOOL DISTRICT
JANSON E.S.: EXTERIOR PAINT AT ENTIRE SITE
8628 MARSHALL ST., ROSEMEAD, CA 91770

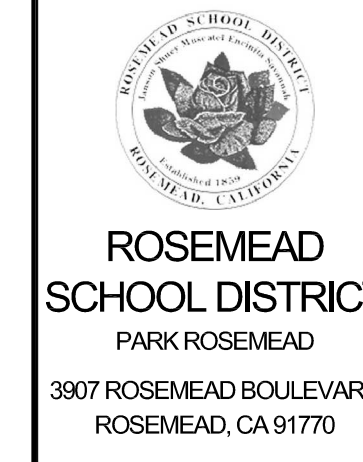

ROSEMEAD SCHOOL DISTRICT
PARK ROSEMEAD
3907 ROSEMEAD BOULEVARD
ROSEMEAD, CA 91770

JUBANY NAC ARCHITECTURE

NAC NO: 161-15094
FILE: 19-96
DRAWN: HH
CHECKED: GC
DATE: 12-01-2020

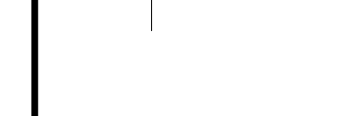

A1.01

KEYNOTES

- ALL (E) EXTERIOR WALLS TO BE PAINTED, ALL (E) FIRST RESPONDERS SIGNAGE TO REMAIN, DO NOT PAINT OVER IT
- ALL (E) EXTERIOR DOORS AND FRAMES TO BE PAINTED, PROVIDE EXTERIOR DOOR BRANDING PER DETAIL: 1/46.01
- REMOVE AND REPLACE (E) T1-11 PANEL IN KIND (MATCH SIZE), SCOPE SHALL INCLUDE REMOVAL OF DAMAGED BUILDING PAPER, INSULATION AND SHT, MTL, FLASHING, RE-DO ANY (E) PAINTED SIGNAGE AFFECTED BY THE REMOVAL OF T1-11 PANELS TO MATCH (E), (N) T1-11 PANELS SHALL BE PRE-FINISHED SMOOTH, PROVIDE ALL NECESSARY WOOD TRIM AT TRANSITIONS AS REQUIRED TO MATCH (E)
- ALL (E) BRONZE ANODIZED METAL WINDOWS (AND WOOD TRIM WHERE APPLICABLE) ON SITE TO BE PAINTED (SPRAY) SAVANNAH ACCENT COLOR INCLUDING ALL SPANDREL PANELS
- REMOVE AND REPLACE ENTIRE LENGTH OF (E) 2" FASCIA BOARD TO MATCH (E), PAINT TO MATCH (E) AND PROVIDE NEW FLASHING TO MATCH (E) GAUGE AT TOP OF FASCIA BOARD (ENTIRE LENGTH).
- PROVIDE (N) PAINT TO WEST, NORTH, EAST AND SOUTH ELEVATIONS OF (E) RELOCATABLE BUILDING
- (E) WATERPROOFING AT BOTTOM OF WALL TO BE REMOVED, PREP LOWER PORTION OF WALL WHERE WATERPROOFING WAS REMOVED FOR APPLICATION OF (N) CEMENT PLASTER FINISH, (N) CEMENT PLASTER ASSEMBLY SHALL INCLUDE (N) BITUTHANE, PAPER AND LATH, PROVIDE 12" MIN. POSITIVE LAP FROM (E) CEMENT PLASTER ASSEMBLY COMPONENTS TO ALL NEW CEMENT PLASTER ASSEMBLY COMPONENTS, (N) CEMENT PLASTER TO MATCH (E) TEXTURE
- REMOVE FIRE HOSE CONNECTION FROM (E) CABINET, CABINET TO BE CONVERTED INTO A DISPLAY CABINET PER DETAIL: 4/A6.01
- (E) WOOD DOOR STOP TO BE REMOVED
- PROVIDE PLASTER PATCH TO 24" A.F.F. TO MATCH (E) TEXTURE AND COLOR
- (E) PLYWOOD PANEL AT WINDOW TO BE REMOVED, IF (E) GLASS IS STILL IN WINDOW ASSEMBLY, PROVIDE BLACK PAINT ON INSIDE FACE OF TOP AND BOTTOM GLAZING PANELS, IF GLASS IS NO LONGER EXISTING BEHIND PLYWOOD, PROVIDE NEW GLASS (MATCH EXISTING) AND PROVIDE BLACK PAINT ON INSIDE FACE OF TOP AND BOTTOM GLAZE PANELS, PROVIDE NEW GASKETS AS RECD, RE-USE GLAZING STOPS, PROVIDE (N) SECURITY SCREEN TO MATCH ADJACENT (E) ONES, PAINT SAVANNAH ACCENT COLOR
- (E) SECURITY SCREEN TO BE REMOVED, PAINTED SAVANNAH ACCENT COLOR PER SPEC AND RE-INSTALLED
- (E) SURFACE MOUNTED SIGN TO REMAIN IN PLACE, (N) PAINT FINISH AT WALL TO BE CAREFULLY APPLIED AROUND (E) SIGN PERIMETER
- ALL (E) GUARDRAILS/HANDRAILS ON SITE TO BE PAINTED SAVANNAH ACCENT COLOR, INCLUDING GUARDRAILS / HANDRAILS WITH (E) PAINT FINISH
- PROVIDE (N) SHT, MTL, FLASHING AT BOTTOM OF (E) WOOD COLUMN
- ALL (E) SHEDS AND CONTAINERS (EXCEPT FOR STORAGE "BARN") ON SITE TO BE PAINTED SAVANNAH ACCENT COLOR PER SPEC, TRIM TO BE PAINTED WHITE (SWISS COFFEE) WHERE OCCURS, DO NOT PAINT OVER (E) LABELS AND ID PLAQUES WHERE OCCURS
- BASE BID: DO NOT PAINT (E) WROUGHT IRON PERIMETER FENCE. ALTERNATE 1: ENTIRE WROUGHT IRON FENCING AND GATES ON SITE TO BE PAINTED (SPRAY) SAVANNAH ACCENT COLOR (DUNN EDWARDS, ARISTOSHIELD), (E) BANNERS MOUNTED ON (E) FENCE SHALL BE REMOVED, STORED, PROTECTED AND RE-INSTALLED AFTER PAINT APPLICATION**
- PROVIDE SAVANNAH ACCENT COLOR PER SPEC TO ALL SIDES OF ALL (E) GUTTERS AND DOWNSPOUTS ON SITE, ALL (E) SHEET METAL EDGE FLASHING AT ROOF (TOP AND VISIBLE FACE) SHALL BE PAINTED SAVANNAH ACCENT COLOR PER SPEC
- PAINT (E) YELLOW CURB TO MATCH (E)
- PROVIDE (N) SAVANNAH ACCENT PAINT (PER SPEC) TO SIDES OF (E) RAMP
- (E) DAMAGED WOOD COLUMN TO BE REMOVED AND REPLACED IN KIND, (E) CAPITAL TO REMAIN (SHORE EXISTING STRUCTURE AS RECD.), PROVIDE PAINT TO MATCH (E)
- PROVIDE (N) PAINT AT (E) BREEZEWAY WALLS, CEILING, DOORS AND HANDRAIL TO MATCH (E)
- (E) BANNER TO BE REMOVED AND RE-INSTALLED AT SAME LOCATION AFTER COMPLETION OF PAINT APPLICATION
- REMOVE (E) T1-11 PANEL FINISH AND PROVIDE (N) CEMENT PLASTER FINISH (FULL HEIGHT) TO MATCH CEMENT PLASTER AT WEST PORTION OF BUILDING
- PROVIDE (N) CEMENT PLASTER PATCH FINISH TO MATCH (E), WORK SHALL INCLUDE REMOVAL AND REPLACEMENT OF DAMAGED WOOD TRIM AT NORTHWEST CORNER
- REMOVE AND REPLACE (E) WOOD TRIM IN KIND, PAINT TO MATCH (E), SEE 2/A6.01
- REMOVE AND REPLACE (E) SHT, MTL, FLASHING PER DETAIL 2/A6.01, NEW FLASHING PROFILE TO PROTECT ENTIRE EXPOSED FACE OF (N) WOOD TRIM, PATCH CEMENT PLASTER AS RECD AND PROVIDE (N) PAINT TO MATCH (E)
- REMOVE AND REPLACE IN KIND THE LAST 12" OF (E) DAMAGED WOOD SISTER JOISTS AT EAVE PER DETAIL 3/A6.01
- (E) CEMENT PLASTER FINISH COAT TO BE REMOVED FULL LENGTH AND HEIGHT OF BUILDING "C" SOUTH WALL (2,000 S.F. APPROX), REPAIR AND FILL ALL CRACKS VISIBLE ON THE EXPOSED BROWN COAT AND PROVIDE (N) CEMENT PLASTER FINISH TO MATCH (E) COARSE TEXTURE (RESTROOMS ENTRANCE), (N) PAINT TO MATCH (E), INCLUDING THE SAVANNAH ACCENT COLOR AT CEMENT PLASTER ADJACENT TO DOORS.
- REMOVE AND REPLACE IN KIND (E) WINDOW TRIM, PROVIDE (N) PAINT TO MATCH (E)
- PROVIDE (N) PAINT (BRICK COLOR) AT (E) CONC. STEPS AND LANDINGS PER PAINT PEC, PROVIDE YELLOW WARNING STRIPE AT TOP OF LANDINGS AND BOTTOM STEP.
- PROVIDE (N) SAVANNAH ACCENT COLOR PAINT (PER SPEC) TO ALL SIDES OF (E) AWNING AND SUPPORT MEMBERS, INCLUDING TOP AND BOTTOM OF AWNING
- PROVIDE PLASTER PATCH AROUND HARD PIPE PENETRATION AND PROVIDE (N) CAULKING
- (E) WOOD TRIM AT METAL WINDOW TRANSOM TO BE PAINTED TO MATCH WINDOW
- (E) CORNER TRIM TO BE REMOVED AND REPLACED IN KIND, PROVIDE (N) SAVANNAH ACCENT COLOR PAINT PER SPEC.
- (E) CMU WALL TO BE PAINTED (SWISS COFFEE BY DUNN EDWARDS)
- (E) BOLLARDS TO BE PAINTED YELLOW PER PAINT SPEC.
- PROVIDE (N) PLASTER PATCH TO MATCH (E) TEXTURE AND FINISH
- (E) WALL MOUNTED MURAL (OVER 4' x 8' PLYWOOD) TO BE REMOVED AND DISCARDED
- PROVIDE BONDO FILL AT (E) WOOD TRIM AS RECD, AND PROVIDE ACCENT COLOR PAINT
- REMOVE AND REPLACE (E) GUTTER; PTD, (ACCENT COLOR, DUNN EDWARDS ARISTOSHIELD) CONNECT TO (E) DOWNSPOUTS.
- REMOVE AND REPLACE (E) GUTTER AND PAINT WITH SAVANNAH ACCENT COLOR
- PROVIDE (N) EXTERIOR GRADE, LOCKABLE ACCESS PANEL AT (E) GAS SHUT-OFF VALVE OPENING LOCATION, (E) CEMENT PLASTER TO BE MODIFIED AS RECD, (N) CEMENT PLASTER TO MATCH (E) TEXTURE AND FINISH
- DOORS LOCATED AT NORTH AND SOUTH ENDS OF BREEZEWAY AT BUILDING "E" TO BE PAINTED ON ALL SIDES TO MATCH (E)

GENERAL SITE NOTES

- ALL DEMOLITION/ALTERATIONS SHALL COMPLY WITH CHAPTER 34 CBC AND CHAPTER 14 CFC.
- REMOVAL AND REPLACEMENT OF (E) T1-11 PANELS SHALL INCLUDE REMOVAL AND REPLACEMENT OF DAMAGED/DETERIORATED CAULKING, BUILDING PAPER, INSULATION AND/OR SHEET METAL FLASHING, PROVIDE NEW BLOCKING/BACKING WERE RECD, TO MATCH IN KIND
- REMOVAL, REPLACEMENT, PATCHING AND ANY NEW CEMENT PLASTER ASSEMBLY SHALL INCLUDE NEW BUILDING PAPER, NEW INSULATION, NEW SHEATHING AND NEW FLASHING WHERE OCCURS AND WHERE RECD, ALL COMPONENTS AND FINISH TO MATCH (E)
- ALL (E) WALL MOUNTED BULLETING BOARD(S), DISPLAY CASE(S) AND SIGNAGE TO BE REMOVED, PROTECTED, STORED AND RE-INSTALLED AT (E) LOCATION AFTER ALL REPAIR(S) AND / OR PAINT APPLICATION IS COMPLETED
- ALL (E) EXTERIOR CONDUIT AND ELECTRICAL BOXES TO BE PAINTED TO MATCH THE COLOR OF THE WALL WHERE INSTALLED, DO NOT PAINT OVER ANY ELECTRICAL WARNING LABELS OF ANY KIND, PAINTING OF (E) CONDUIT AND/OR PIPES ABOVE CANOPIES ARE NOT INCLUDED IN THE SCOPE OF WORK
- APPLICATION OF (N) PAINT AT (E) SURFACES SHALL INCLUDE POWER WASHING OF (E) SURFACE PER PAINT SPEC, (E) SURFACES TO BE PAINTED SHALL INCLUDE: WALLS, CEILINGS, UNDERSIDE OF CANOPIES, CANOPY POSTS, UNDERSIDE OF EAVES, EXTERIOR DOORS, WINDOWS, POSTS COLUMNS, ETC. ALL (E) PEELING AND/OR BUBBLING PAINT FINISH TO BE REMOVED PRIOR TO PAINT APPLICATION PER SPEC
- ALL (E) CLEAR/NATURAL ANODIZED METAL WINDOWS ON SITE TO REMAIN AS IS, NO (N) PAINT REQUIRED
- SCOPE OF WORK INCLUDES RE-ATTACHMENT OF ALL (E) POPPED NAILS AND/OR SCREWS IN THE AREA OF WORK
- SCOPE OF WORK SHALL INCLUDE NEW CAULKING AT T1-11 PERIMETER AS REQUIRED PRIOR TO PAINTING (TO MATCH EXISTING)
- PROVIDE NEW SEALANT AT ALL CONDUIT PENETRATIONS INCLUDED IN THE SCOPE OF WORK
- NO PARTS OF THE FIRST RESPONDERS BUILDING IDENTIFICATION LABELING SHOULD BE COVERED OR BLOCKED BE THE NEW PAINTING SCOPE OF WORK, SEE DETAIL 5/A6.01 SHOULD AN (E) FIRST RESPONDERS SIGNAGE BECOMES COVERED W/ (N) PAINT
- PAINT SCOPE DOES NOT INCLUDE PAINTING OF (E) TRANSFORMER(S) OR SWITCHGEAR(S)
- GAS LINE PAINT NOTES - VERTICAL ON WALLS
- SCRAPE (E) PAINT AT EAVES AND PROVIDE PAINT
- EXISTING WALL MOUNTED UNITS (NOT TO BE PAINTED) TO BE PROTECTED IN PLACE
- PORTIONS OF (E) WINDOW WOOD TRIM PROJECTING BEYOND THE PLASTER FACE FINISH SHALL BE PAINTED SAVANNAH ACCENT COLOR
- PAINTING OF DOWNSPOUTS TO INCLUDE THE FULL LENGTH OF THE DOWNSPOUT, FROM GUTTER TO DISCHARGE AT BOTTOM
- ALL (E) PORTIONS OF CMU WALLS THAT ARE NOT CURRENTLY PAINTED, SHALL REMAIN WITHOUT PAINT, PROTECT IN PLACE.

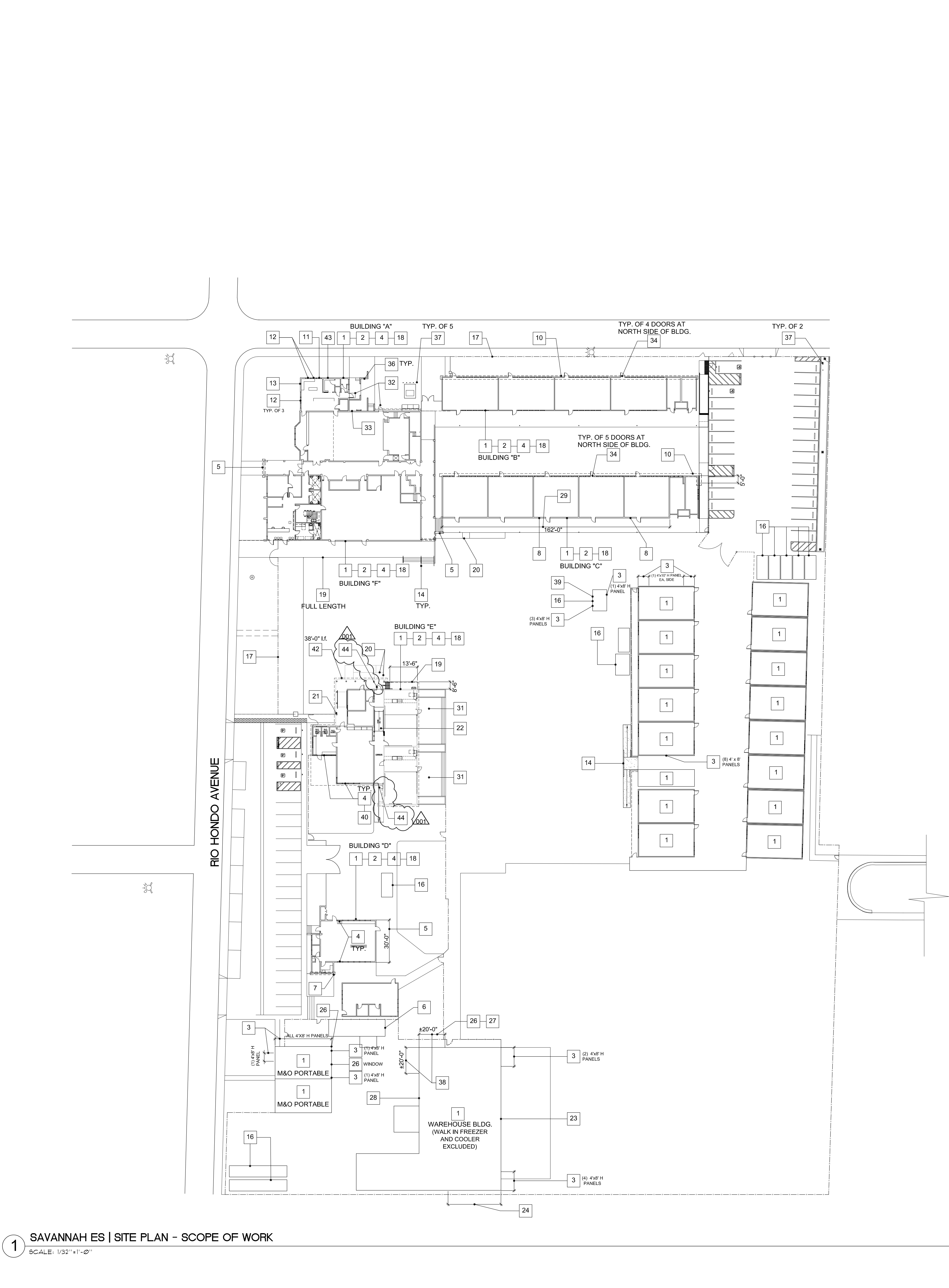

1 SAVANNAH ES | SITE PLAN - SCOPE OF WORK
SCALE: 1/32" = 1'-0"

ADDENDUM 001 | 03/03/2021

RECEIVED ARCHITECTURE
HELENA J. JUBANY
22214
JAN 5-31-25
STATE OF CALIFORNIA

CHANGES, SPECIFICATIONS AND OTHER NOTES ARE TO BE MADE BY THE ARCHITECT AND NOT BY THE CONTRACTOR. THE CONTRACTOR SHALL BE RESPONSIBLE FOR OBTAINING ALL NECESSARY PERMITS AND FOR OBTAINING ALL NECESSARY INFORMATION FROM THE CITY AND COUNTY OF LOS ANGELES. THE CONTRACTOR SHALL BE RESPONSIBLE FOR OBTAINING ALL NECESSARY INFORMATION FROM THE CITY AND COUNTY OF LOS ANGELES. THE CONTRACTOR SHALL BE RESPONSIBLE FOR OBTAINING ALL NECESSARY INFORMATION FROM THE CITY AND COUNTY OF LOS ANGELES.

ROSEMEAD SCHOOL DISTRICT
SAVANNAH E.S. - EXTERIOR PAINT AT ENTIRE SITE

3720 RIO HONDO AVE. ROSEMEAD, CA 91770

ROSEMEAD SCHOOL DISTRICT
PARK ROSEMEAD
3907 ROSEMEAD BOULEVARD
ROSEMEAD, CA 91770

ROSEMEAD SCHOOL DISTRICT
PARK ROSEMEAD
3907 ROSEMEAD BOULEVARD
ROSEMEAD, CA 91770

JUBANY
NAC
ARCHITECTURE

NAC NO 161-15094
FILE 19-96
DRAWN HH
CHECKED GC
DATE 01-08-2021

161-15094
19-96
HH
GC
01-08-2021

A1.01

